

# W2R

*By AquaExpert W&PS*

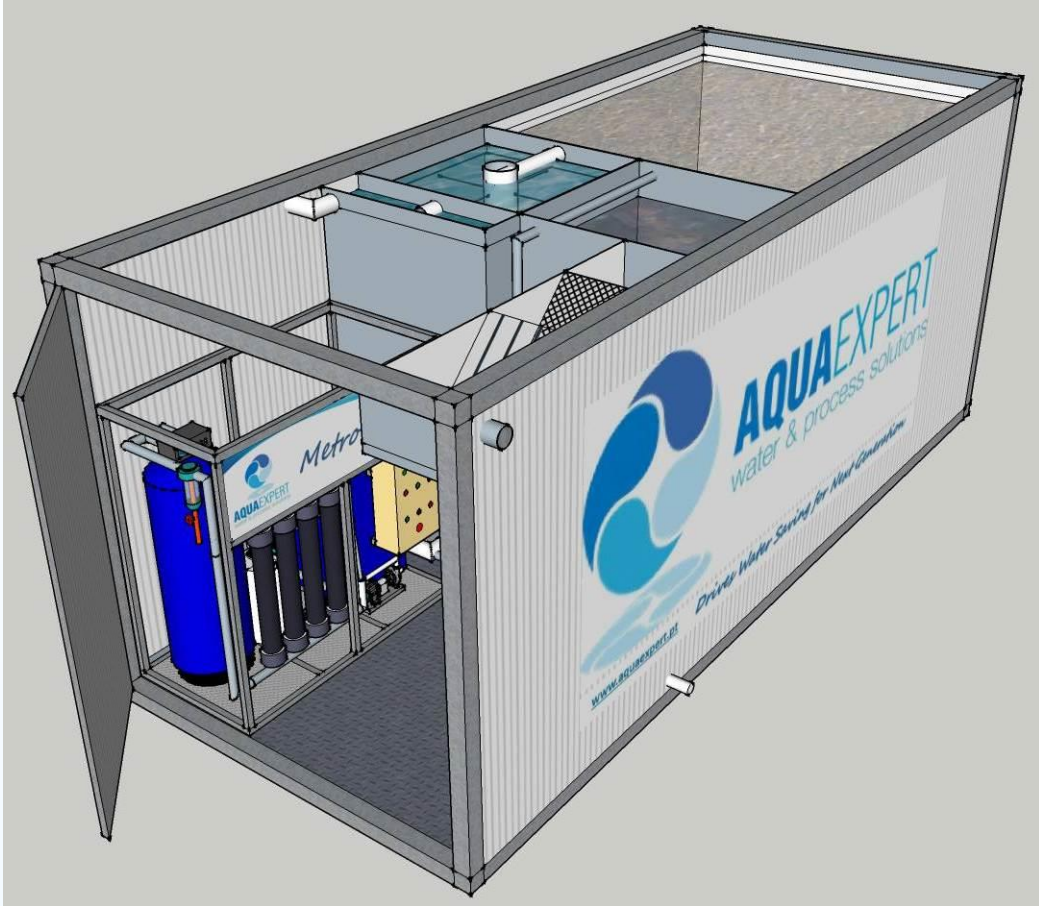

*Waste to Reuse*

*Drives Water Saving for Next Generation*

# W2R

By AquaExpert W&PS

- Industry** Domestic and Industrial Effluent
- Application** Waste Water Treatment and Reuse
- Technology** Activated Sludge Process
- Capacity** 15 a 100 m<sup>3</sup>/day by unit
- Description** Totally operational mobile units for treatment of waste water from 100 to 400 PE with reuse system for 5 m<sup>3</sup>/h.

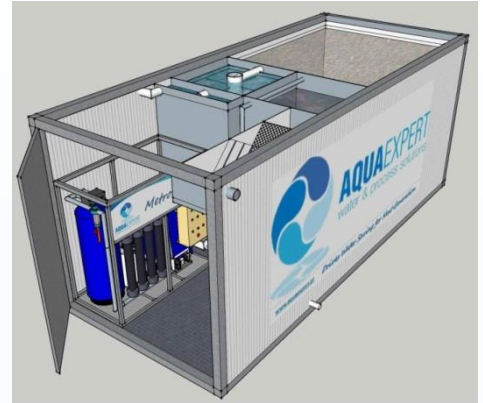

Built in a 20 feet ISO container.

Includes manual for start-up and commissioning.

Units are totally automatic with electric cabinet.

Alarms and failure will be received as an SMS in your mobile phone.

Can be shipped all over the world.

*Plug & Play* system installation.

Fully tested before shipping.

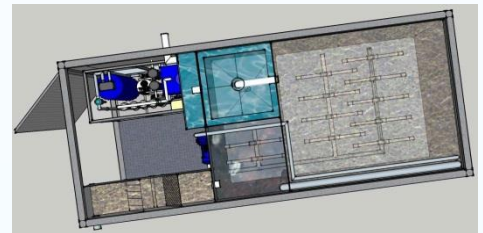

# W2R

By AquaExpert W&PS

Data	W2R-100	W2R-200	W2R-300	W2R-400
Q <sub>24</sub> (m <sup>3</sup> /d)	15 - 25	25 - 50	45 - 75	60 - 100
Capacity (PE)	80 - 120	180 - 220	280 - 320	380 - 420
BOD <sub>5</sub> (kg/d)	4,8 - 7,2	10,8 - 13,2	16,8 - 19,2	22,8 - 25,2
Length	6,058	6,058	12,192	12,192
Height	2,438	2,438	2,438	2,438
Width	2,438	2,438	2,438	2,438
Weight (kg)	5 000	5 000	8 500	8 500
Installed Power	4 kw	7 kw	10 kw	12 kw
Average Consumption	3 kwh	6 kwh	8 kwh	10 kwh
Reuse Water <i>MetroPure</i>	1-2 m <sup>3</sup> /h MP13	1-3 m <sup>3</sup> /h MP13	1-4 m <sup>3</sup> /h MP25	1-5 m <sup>3</sup> /h MP25

### Legend:

- ① Inlet Screening
- ② Equalization and Anoxic Tank
- ③ Aerated Biological Tank
- ④ Secondary Sedimentation Tank
- ⑤ Clarified Water Tank
- ⑥ Reuse Unit - **MetroPure**
- ⑦ 20 ft ISO Container

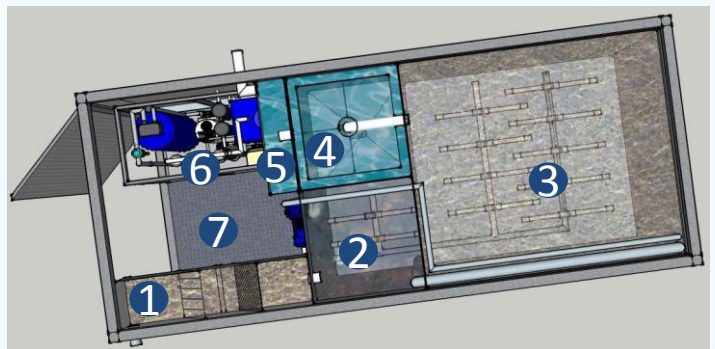

*Drives Water Saving for Next Generation*



**AQUAEXPERT**  
water & process solutions

# *Creating for you...*

## **ANGOLA**

Condomínio Horizonte Sul, n.º A-14  
Talatona  
Luanda – Angola  
T: +244 222 336 789  
F: +244 222 360 897  
M: +244 945 200 021

## **PORTUGAL**

Zona Industrial Vale do Alecrim  
Rua do Zinco, Lote 104  
2950-007 Palmela - Portugal  
T: +351 212 360 629  
F: +351 212 385 363  
E: [geral@aquexpert.pt](mailto:geral@aquexpert.pt)

*Drives Water Saving for Next Generation*