

# UFRO

*By AquaExpert W&PS*

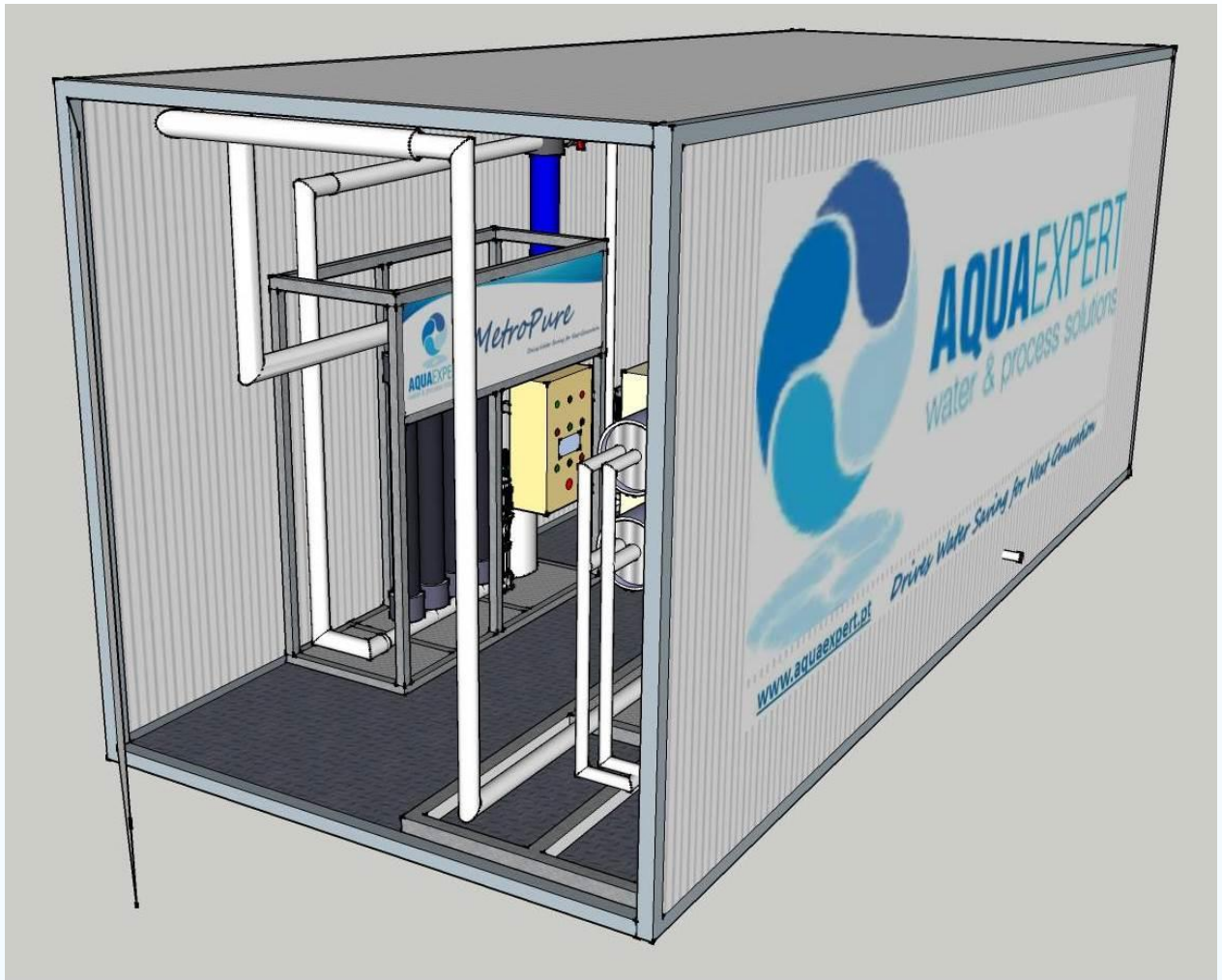

*Advanced Potable Solutions*

*Drives Water Saving for Next Generation*

# UFRO

By AquaExpert W&PS

- Industry** Domestic and Industrial
- Application** Potable Water for Human Consumption
- Technology** Ultra-Filtration and Reverse Osmosis
- Capacity** 50 a 600 m<sup>3</sup>/day by unit
- Description** Totally operational mobile units for treatment

of raw water to produce pure water free of virus and bacteria's.

Built in a 20 feet ISO container.

Includes manual for start-up and commissioning.

Units are totally automatic with electric cabinet.

Alarms and failure will be received as an SMS in your mobile phone.

Can be shipped all over the world.

*Plug & Play* system installation.

Fully tested before shipping.

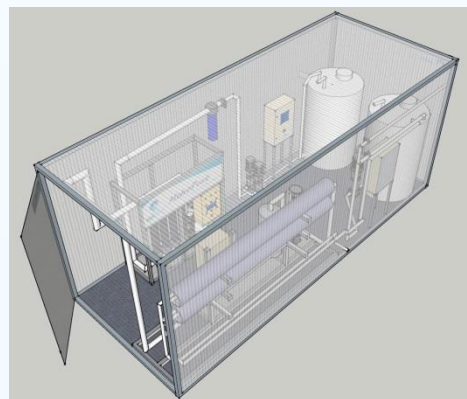
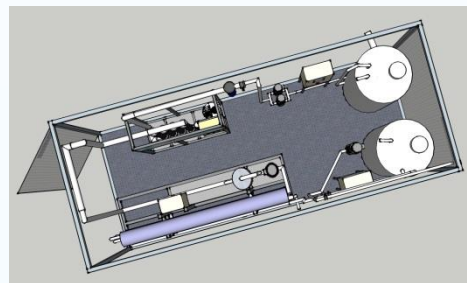
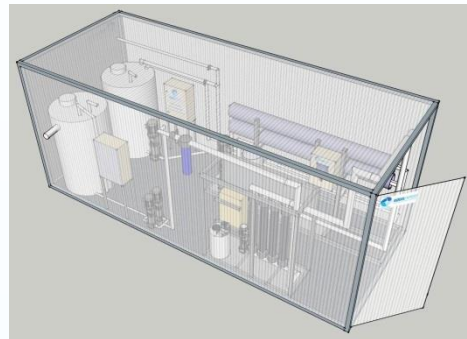

# UFRO

*By AquaExpert W&PS*

<i>Data</i>	<i>UFRO-084</i>	<i>W2R-168</i>	<i>W2R-336</i>	<i>W2R-600</i>
Pure Water Flow (m <sup>3</sup> /h)	4,25	8,5	15	25
Capacity (m <sup>3</sup> /d)	100	200	350	630
Length	6,058	6,058	6,058	6,058
Height	2,438	2,438	2,438	2,438
Width	2,438	2,438	2,438	2,438
Weight (kg)	5 000	7 000	8 500	10 500
Installed Power	4 kw	7 kw	10 kw	13 kw
Average Consumption	3 kwh	6 kwh	8 kwh	11 kwh
Pre-Treatment <i>MetroPure</i>	1-8 m <sup>3</sup> /h MP38	1-12 m <sup>3</sup> /h MP410	3-16 m <sup>3</sup> /h 2 X MP38	4-25 m <sup>3</sup> /h 2 X MP410

**Legend:**

- ① Inlet Tank
- ② Pressurization Pump
- ③ *MetroPure*
- ④ Reverse Osmosis Skid
- ⑤ Recirculation Pump and Chlorination
- ⑥ Pure Water Tank
- ⑦ 20 ft ISO Container

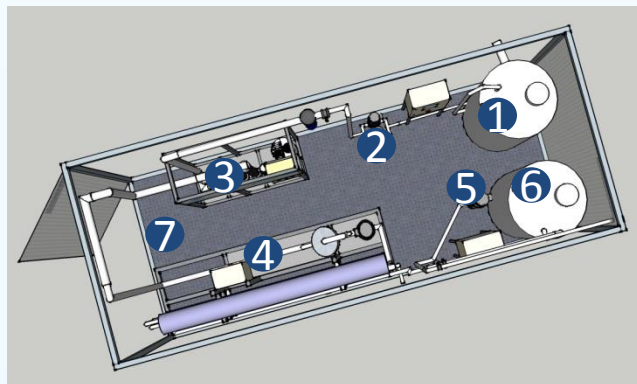

*Drives Water Saving for Next Generation*



**AQUAEXPERT**  
water & process solutions

# *Creating for you...*

## **ANGOLA**

Condomínio Horizonte Sul, n.º A-14  
Talatona  
Luanda – Angola  
T: +244 222 336 789  
F: +244 222 360 897  
M: +244 945 200 021

## **PORTUGAL**

Zona Industrial Vale do Alecrim  
Rua do Zinco, Lote 104  
2950-007 Palmela - Portugal  
T: +351 212 360 629  
F: +351 212 385 363  
E: [geral@aquexpert.pt](mailto:geral@aquexpert.pt)

*Drives Water Saving for Next Generation*